

GCV1100 Metro/Makro round Vitrine

Version no.: 1
 Documents Valid from - to: GCV1100 VIV - now

Example	Explanation Lot-no.: "Model-no." + "Capital letter for the year" + "Romanian numbers for the month"												
	RTW-100L-2 --> Production date March 2016												
	RTW-100L-2 --> Production date October 2018												
Year	Q	R	S	T	U	V	W	X	Y	Z			
	2015	2016	2017	2018	2019	2020	2021	2022	2023	2024			
Month	Jan	Feb	Mar	Apr	May	Jun	Jul	Aug	Sep	Oct	Nov	Dec	
	I	II	III	IV	V	VI	VII	VIII	IX	X	XI	XII	

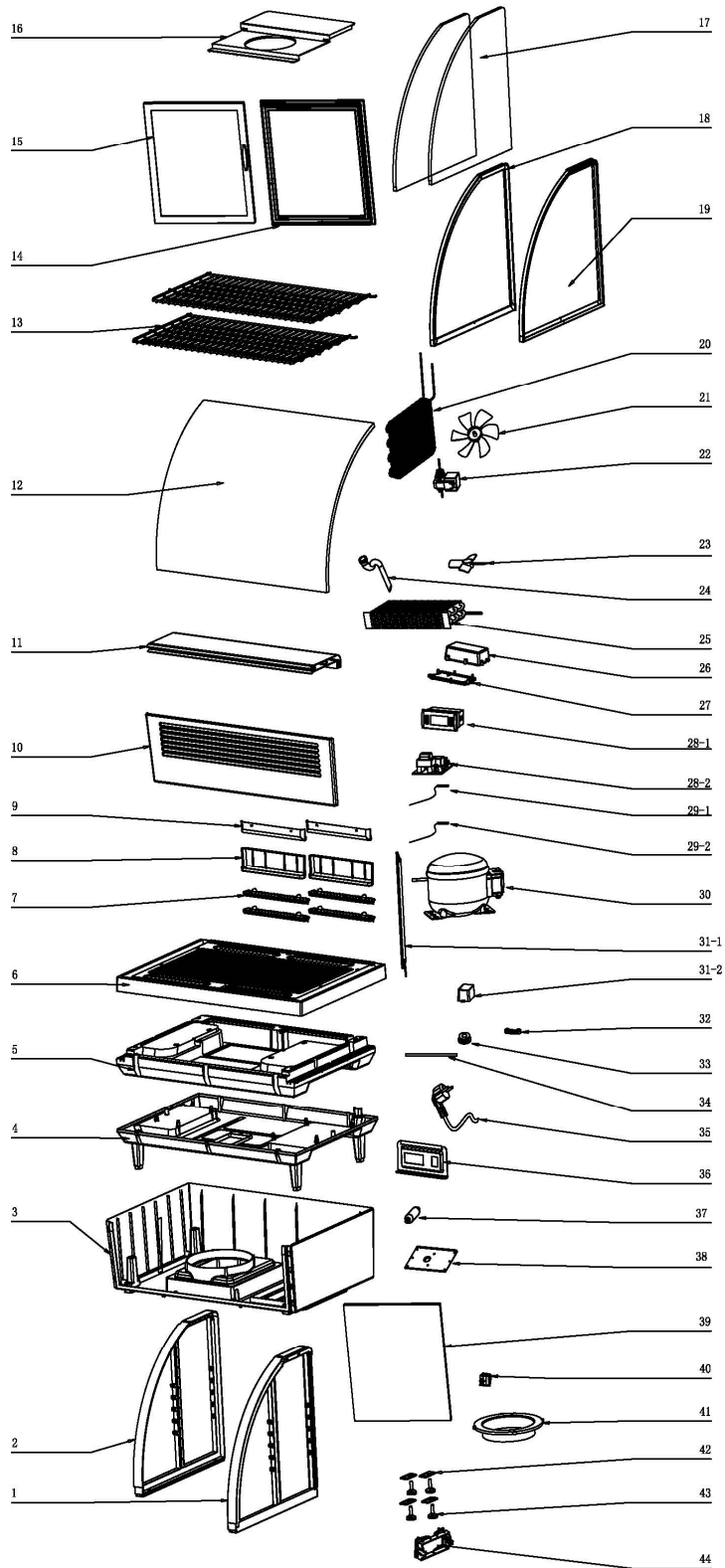

Item No.	Supplier spare part number	Name	QTY
1	1.1.C.C46.04.01	Left Panel	1
2	1.1.C.C46.04.02	Right Panel	1
3	1.1.C.C46.04.05	Base	1
4	1.1.C.C46.04.04	Plastic Base Of Evaporator	1
5	1.1.D.D08.02.35	Foam Of Evaporator	1
6	1.1.C.C46.04.03	Bottom Panel For Air Suction And Air Outlet	1
7	1.1.C.C46.04.12	Air Outlet Cover	4
8	1.1.C.C46.04.13	Front Air Outlet Base	2
9	1.1.C.C46.04.14	Rear Air Outlet Base	2
10	1.1.C.C46.04.09	Front Frame	1
11	1.1.C.C46.04.11	Rear Upper Crosshand	1
12	1.1.E.E2.08.46	Curve Front Glass	1
13	1.1.B.B02.05.03	Shelves	2
14	1.1.C.C46.01.09	Inner Door Frame	2
15	1.1.C.C46.01.10	Outer Door Frame	2
16	1.1.C.C46.04.15	Evaporator Protect Board	1
17	1.1.E.E2.08.47	Side Glass	2
18	1.1.C.C46.04.06	Right Rubber Ring	1
19	1.1.C.C46.04.07	Left Rubber Ring	1
20	1.1.A.A09.55	Condenser	1
21	1.1.A.A03.01.59	Fan Blade Of Evaporator	1
22	1.1.A.A03.01.73	Fan Motor	1
22	1.1.A.A03.05.15	Fan Motor	1
23	1.1.C.C17.04	Fan Blade Of Condenser	1
24	1.1.C.C41.13	Bottom/upper Water Tube	1
25	1.1.A.A10.85	Evaporator	1
26	1.1.C.C21.03	Contro Box	1
27	1.1.C.C22.07	Control Box Cover	1
28-1	1.1.A.A17.06.01	Digital Controller	1
28-2	1.1.A.A17.01.01	Main Circuit Board	1
29-1	1.1.L.L24.04.03	Temperature Probe	1
29-2	1.1.L.L24.04.04	Defrost Probe	1
30	1.1.A.A02.01	Compressor	1
31-1	1.1.A.A01.14.37	LED Light	2
31-2	1.1.A.A01.10.30	LED Power Drive	1
32	1.1.C.C24.03	Wire Clip	1
33	1.1.C.C41.01	Motor Fixed Ring	1
34	1.1.B.B06.26	Charging Pipe	1
35	1.1.A.A08.02.87	Power Cord	1
36	1.1.C.C46.04.08	Control Panel	1
37	1.1.A.A04.01	Dry Filter	1
38	1.1.B.B17.04	Metal Fan Blade	1
39	1.1.E.E02.02.39	Door Glass	2
40	1.1.A.A07.10	Switch	1
41	1.1.C.C46.04.16	Condenser Air Duct	1
42	1.1.B.B09.16	Flag Gasket	4
43	1.1.C.C32.18	Adjustable Feet	4
44	1.1.C.C34.03	Control Bracket	1